

LEGENDE BESTAND table with 4 columns: Symbol, Name, and Description for various engineering elements like fences, lighting, and structures.

LEGENDE table with 4 columns: Symbol, Name, and Description for various surface types like asphalt, concrete, and gravel.

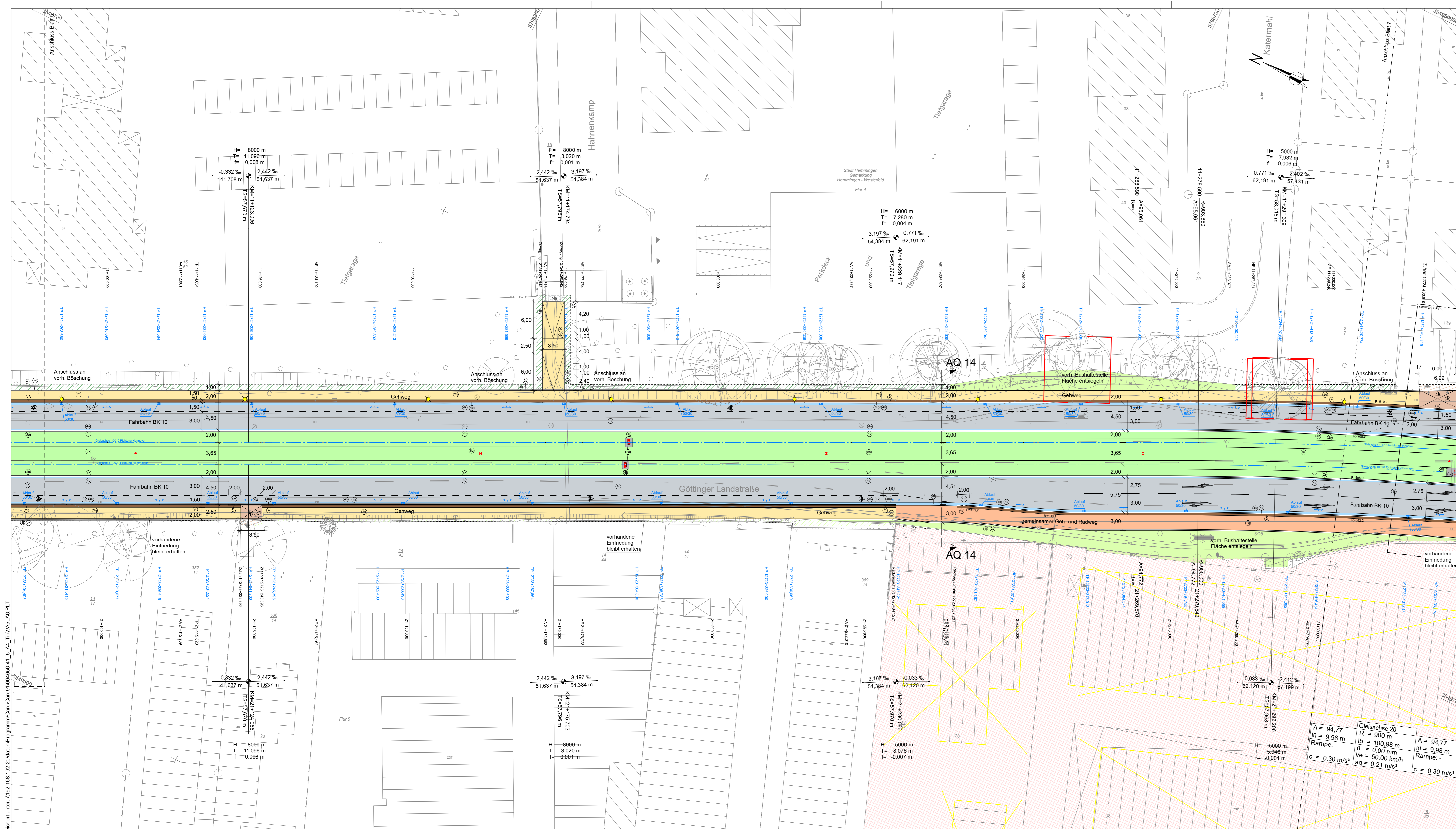

LEGENDE

LEGENDE table with 4 columns: Symbol, Name, and Description for surface and material types.

Material Straßenbau table with 4 columns: Code, Name, and Description for road construction materials.

Material Gleisbau table with 4 columns: Code, Name, and Description for railway track construction materials.

Zeichenerklärung table with 4 columns: Symbol, Name, and Description for specific drawing symbols.

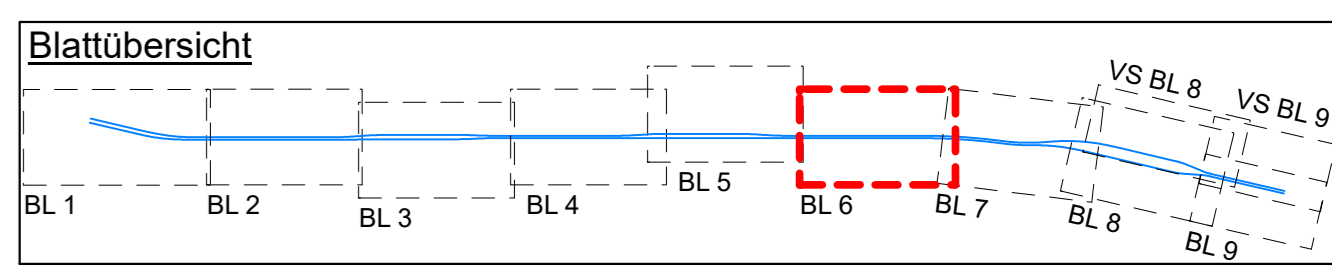

Administrative table for document approval, including fields for 'Nach § 60 BOSTrab zugestimmt' and approval dates.

Administrative table for document approval, including fields for 'Niedersächsische Landesbehörde für Straßenbau' and approval dates.

Administrative table for document approval, including fields for 'Region Hannover' and approval dates.

Administrative table for document approval, including fields for 'ÜSTRA' and approval dates.

Project information section including project name 'Stadtbahnstecke A-Süd', drawing title 'Stadtbahnverlängerung (B3)', and scale 'M 1: 250'.

Watermark and date information: 'VORABZUG 16.12.19' and 'Vermessung TTb von Dezember 2017'.